

John Crawford

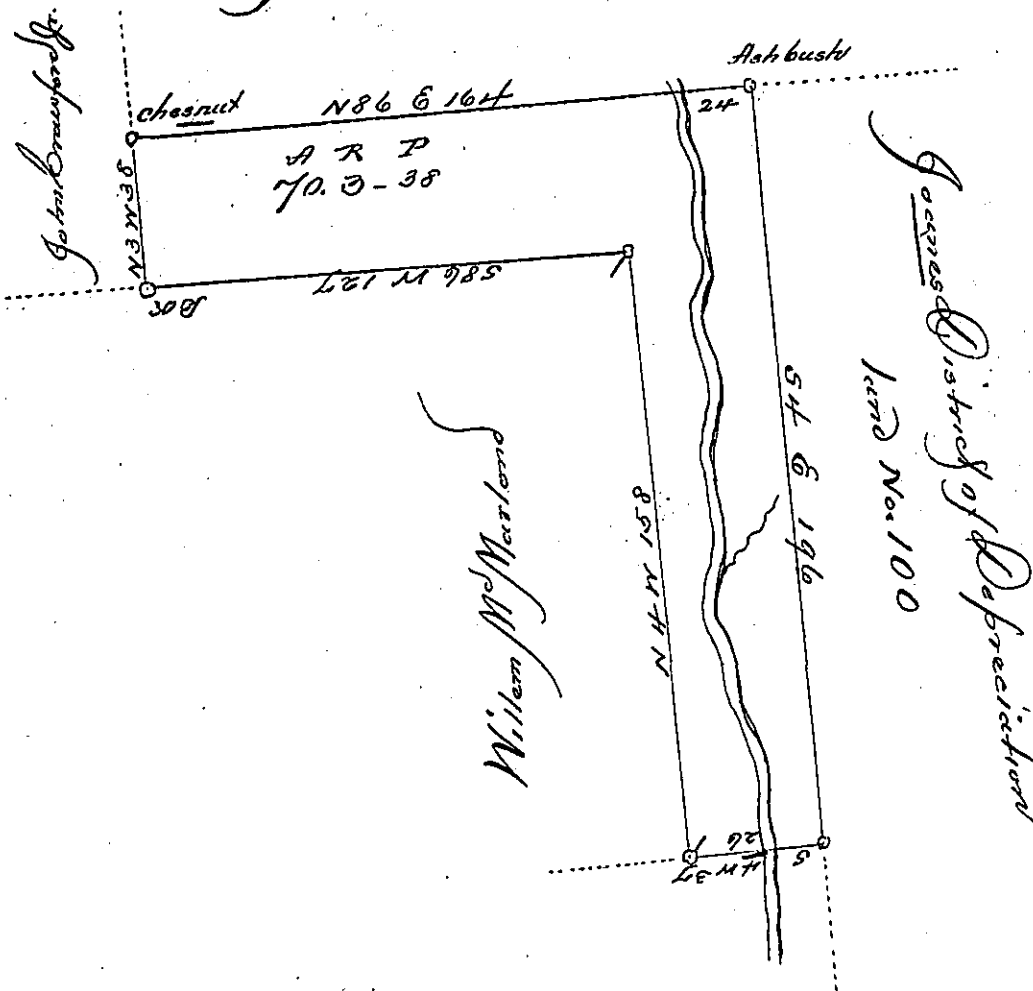

A Draught of a survey executed Dec^r 22^d 1826, for Sarah Cumberland
 situated on the waters of Pine Creek, Pine Township, containing seven
 acres three rods and thirty eight perches and allowance of six feet
 Note, at the time of making the above survey, the said Sarah Cumberland
 land was residing on said land and engaged in improving the same.

Gabriel Hiestor Jr. Esq.
 S^r

R. Filand's d^r

NB. the above land is Northwest the rivers Ohio & Allegheny

IN TESTIMONY that the above is a copy of the original remaining on file in
 the Department of Internal Affairs of Pennsylvania, made
 conformably to an Act of Assembly approved the 16th day of
 February, 1833, I have hereunto set my Hand and caused
 the Seal of said Department to be affixed at Harrisburg,
 this twenty second day of April 1904

James P. [Signature]
 Secretary of Internal Affairs.